



Compromisso com a qualidade

## Installation guide and Maintenance of vacuum pumps

### ATTENTION:

When installing the pump in a new or used milking machine, always use original muffler Triunfo.

After installing the pump, use a soaked in diesel oil, kerosene or detergent and clean, of the vacuum tubing by removing drilling burrs, powder or milk from the inside of the pipe.

Repeat this cleaning operation 3 times.

### TRIUMPH WARRANTY TERM

This product is guaranteed by Triunfo Bombas of Vacuum against manufacturing defects, during the period of 01 (one) year from the date of acquisition, duly substantiated with the purchase invoice

#### Fills of data

(Required field on the date of purchase, fix in the invoice)

Product \_\_\_\_\_  
Resale \_\_\_\_\_  
Address \_\_\_\_\_  
Purchase date \_\_\_\_\_  
Invoice \_\_\_\_\_

Opening, maintaining and assembling the pump should be performed manually with the following tools:



Hamm



Against  
pin



Lima half cane /  
boring boring

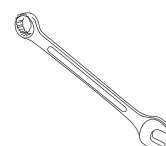

Key 13 mm  
or 1/2



Sandpaper  
80, 100 or  
120



cloth



Hidráulico oil  
ISO 68

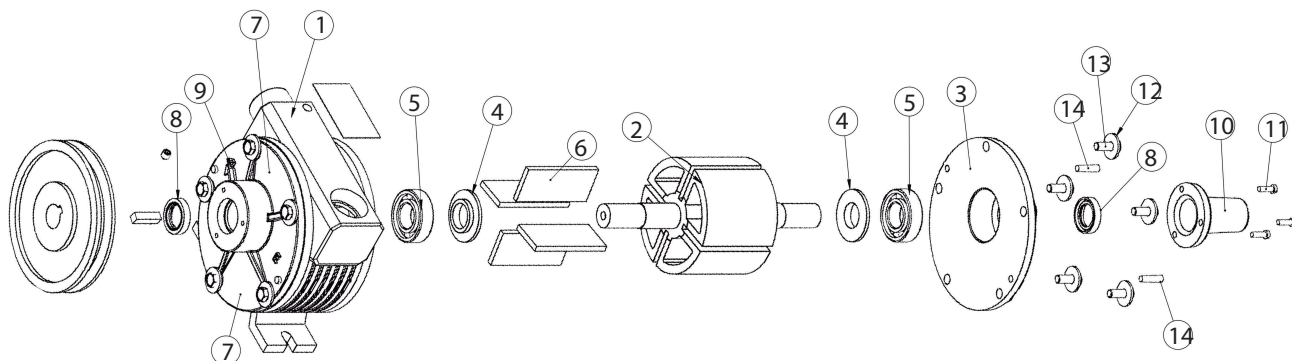

ITEM NUMBER	NAME OF PARTS	QDT
1	CARCASS	1
2	ROTOR	1
3	RIGHT COVER	1
4	ROLLING STOCK 6205	2
5	PART BEARING	2
6	STRAWS	4
7	LEFT COVER	1
8	RETAINER	2
9	LUBRICATION NIPPLE	2
10	SHAFT PROTECTOR	1
11	SCREW SLOT M5	3
12	WASHER M8	10
13	HEXAGON SOCKET HEAD SCREW M8	10
14	GUIDE PIN	4

### Pump opening:

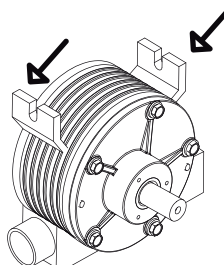

1. On a flat surface, smooth and free from dirt position the pump with the feet up

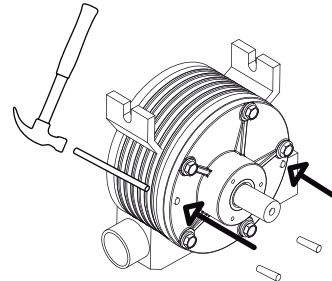

2. With the aid of a hammer and a against pin, knock on the sides of the pump, and remove the 2 pins

NEVER TAP WITH THE HAMMER ON ANY OTHER PART OF THE PUMP, USE IT ONLY TO REMOVE AND PLACE THE PINS

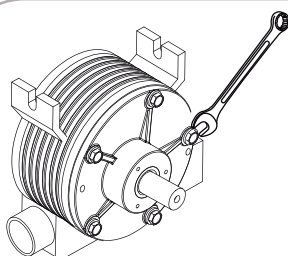

3. After removing the 2 pins, use a 13 mm wrench and remove the 5 screws

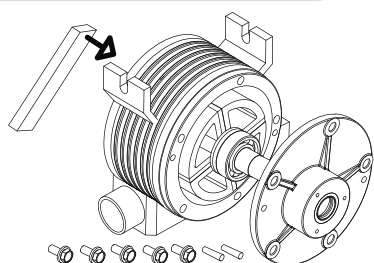

4. With the pins and screws removed, remove the housing cover. If you do not release easily, use piece of wood and tap the other end of the rotor shaft

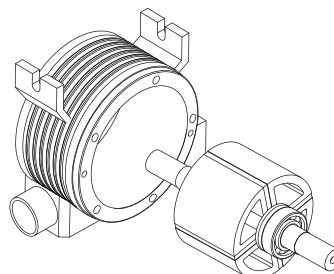

5. Finally remove the rotor from the housing

### Reed reduction:

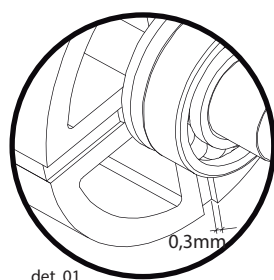

det. 01

0 1cm  
0,3mm

1. The side "a" and "b" of the vanes should be smaller than the rotor: 0.3 to 0.4 mm (in BVT1 pumps) and 0.4 to 0.5 mm (in BVT2, BVT3, BVT4 pumps), on each side.

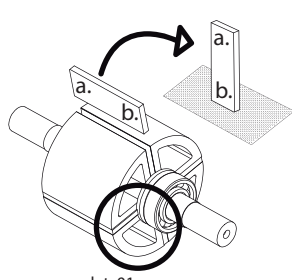

det. 01

2. If the blade is larger than specified, remove it and wear it on the side "a" or "b" on 80, 100 or 120 grit sandpaper. Wipe the powder and re-insert it.

### Removal of imperfections in the housing and cover:

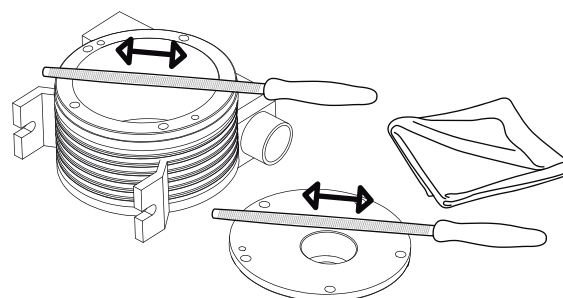

1. To remove imperfections that may have occurred with the beats, use a flat, thin file and gently stroke the front of the housing and the inside of the cover. Then wipe off the powder with a dry cloth.

### Mounting the pump:

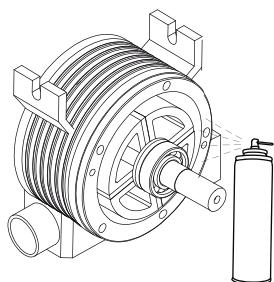

1. Attach the rotor to the housing and add ISO 68 hydraulic oil.

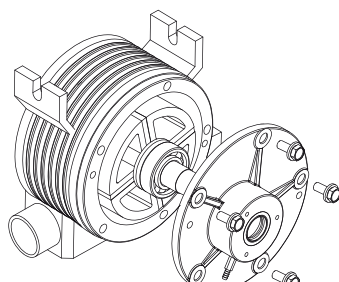

2. Attach the cover and screw the screws in with your hands, without tightening them.

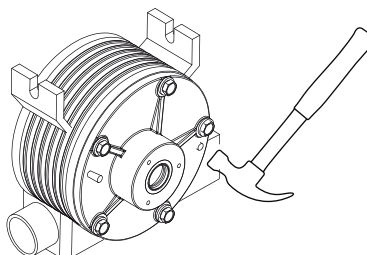

3. Insert the 2 pins and close the insert with a hammer

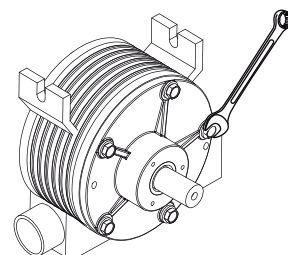

4. Finally tighten the screws with a 13 mm wrench.